

**VANCE
CEMETERY**

FRANKLIN CO. BLENDON TWP.

OFFICIAL PROJECT NO'S. 465 42 3 467 & 665 42 3 232

LEGEND	HISTORY
① REVOLUTIONARY WAR.	EST. AB'T. 1810. AS EVID'NC'
⑩ WAR OF 1812.	D. BY CONV'ES. OF JON'T'N
⑯ WAR WITH MEXICO.	DAYTON TO ALEX. VANCE
⑰ CIVIL WAR.	IN 1804. CONV'D. TO JOS'P.
⑳ SPANISH AM. WAR.	VANCE. ORIGN'LY. GR'NT'D.
㉑ WORLD WAR.	TO JON'T'N. DAY'T'N. BY U.S.
	IN 1800. 0.015 ACRE.

SCALE 1"=20'

25-1-4

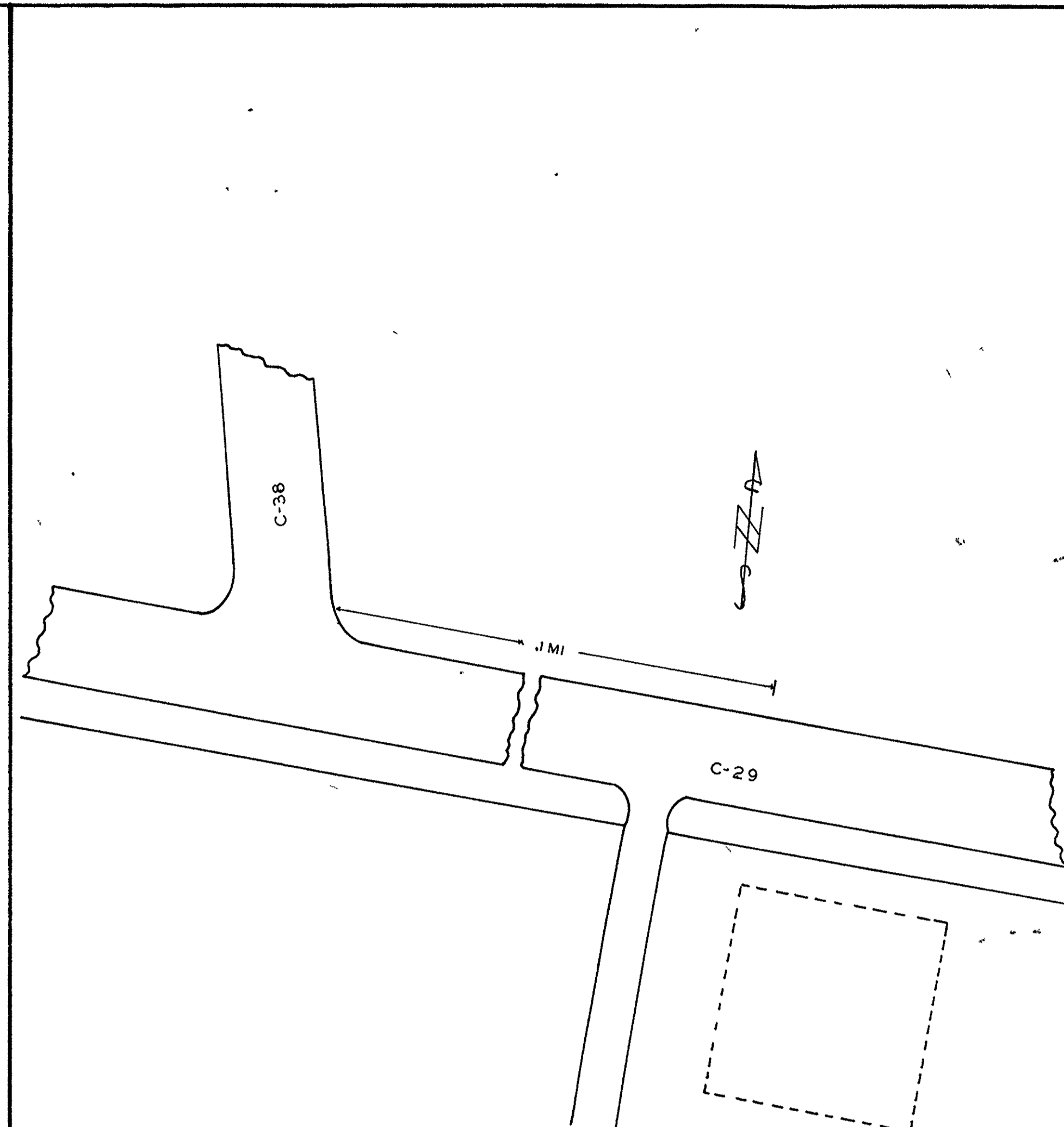

**BAPTIST
CEMETERY**

FRANKLIN CO. BROWN TWP.

OFFICIAL PROJECT NO'S. 465-42-3-467 & 665-42-3-232

LEGEND	HISTORY
① REVOLUTIONARY WAR.	EST. DATE UNKN. PART O-
⑩ WAR OF 1812	F VA. MIL. LAND PAT. TO
⑯ WAR WITH MEXICO.	EDW. CARINGTON, JOHN
⑰ CIVIL WAR.	MARSHALL, HENRY & HAR-
⑳ SPANISH AM. WAR.	RY HETH 1813. CONV'D. TO
㉑ WORLD WAR.	M.L. SULLIVANT IN 1847
	0.01 ACRE

SCALE 1"=20'

25-2-1

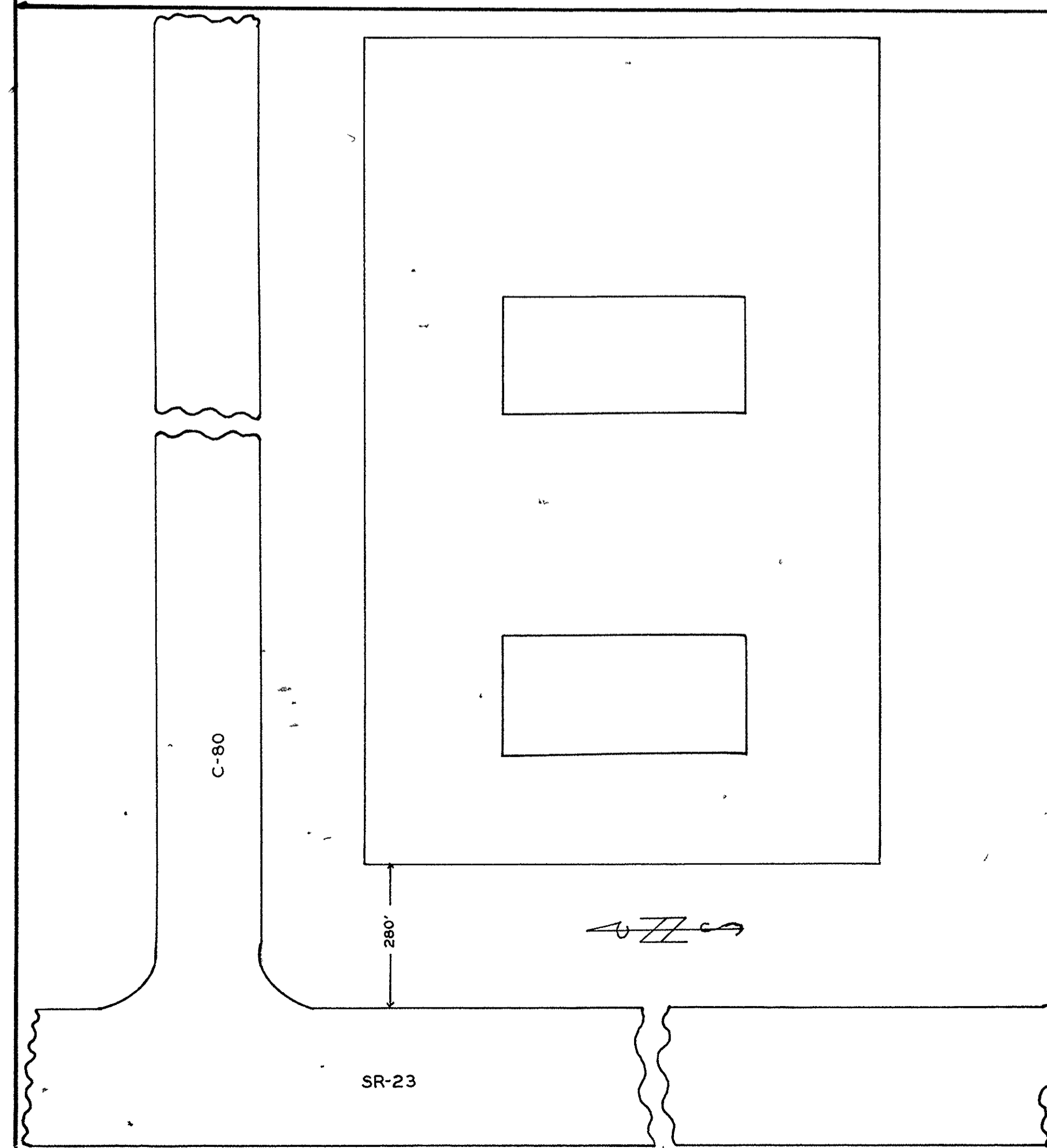

**WEBSTER
CEMETERY**

FRANKLIN CO. CLINTON TWP.

OFFICIAL PROJECT NO'S. 465-42-3-467 & 665-42-3-232

LEGEND	HISTORY
① REVOLUTIONARY WAR.	ESTABLISHED 1867. PART
⑩ WAR OF 1812.	OF THE U.S. MILITARY
⑯ WAR WITH MEXICO.	LAND PATENTED TO
⑰ CIVIL WAR.	JOHN RATHBONE JAN.
⑳ SPANISH AM. WAR.	23-1800.
㉑ WORLD WAR.	

SCALE 1"=20' 0.37 ACRE.

25-3-5

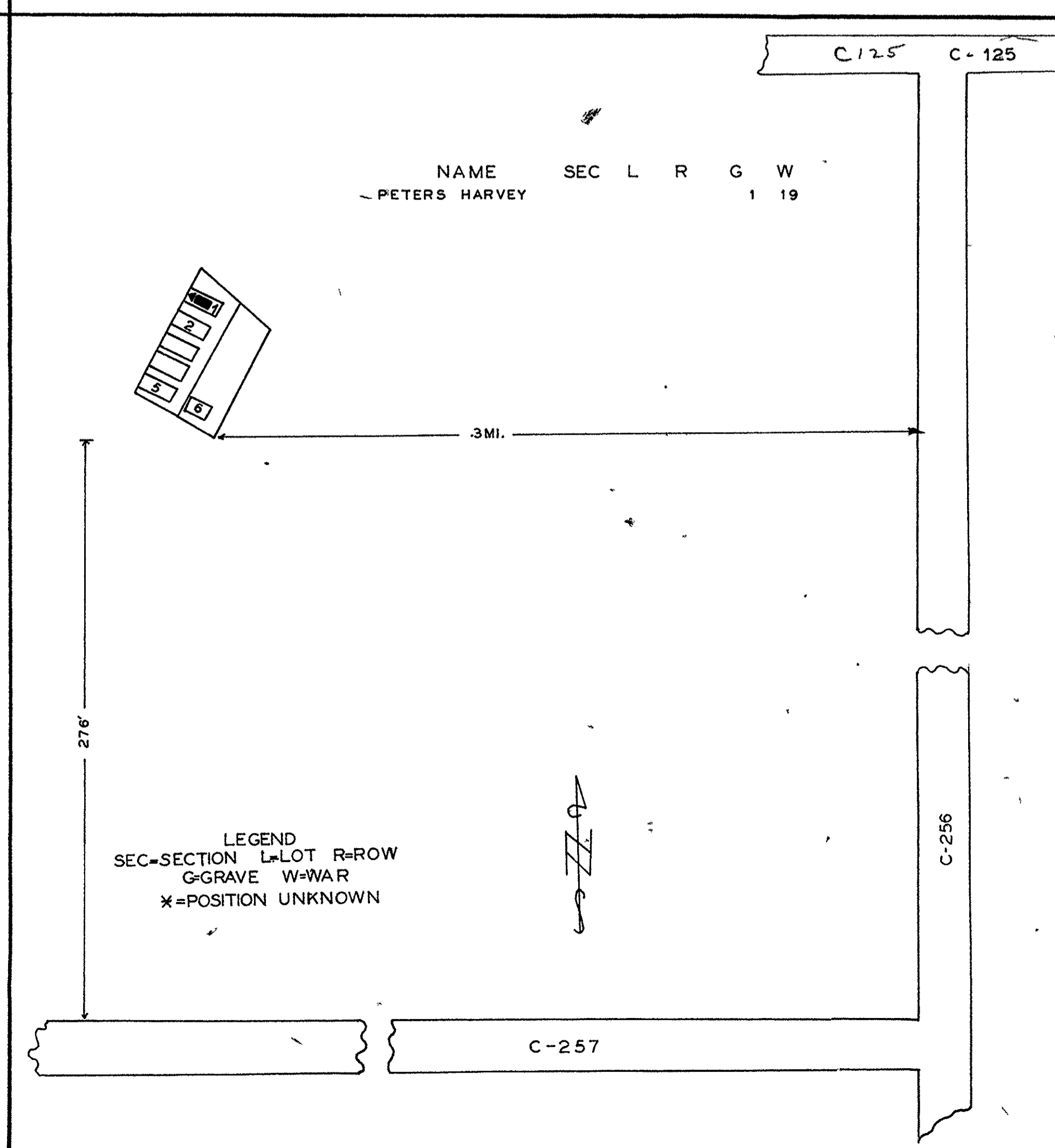

NAME	SEC	L	R	G	W
PETERS HARVEY				1	19

LEGEND
SEC=SECTION L=LOT R=ROW
G=GRAVE W=WAR
X=POSITION UNKNOWN

**PETERS
CEMETERY**

FRANKLIN CO. FRANKLIN TWP.

OFFICIAL PROJECT NO'S. 465 42 3 467 & 665 42 3 232

LEGEND	HISTORY
① REVOLUTIONARY WAR.	APPROX. EST. 1851 PART
⑩ WAR OF 1812.	OF THE VA. MIL. LAND
⑯ WAR WITH MEXICO.	PAT. TO CAP. ROBERT
⑰ CIVIL WAR.	BEAL BY U. S. PRES. JNO.
⑳ SPANISH AM. WAR.	ADAMS IN 1800. FOR SE-
㉑ WORLD WAR	RV'S. IN THE REV. ARMY.
	0.01 ACRE.

SCALE 1"=20'

25-4-10