

**WOODYARD
CEMETERY**

FRANKLIN CO. JEFFERSON TWP.
OFFICIAL PROJECT NO'S. 465-42-3-467 & 665-42-3-232

LEGEND	HISTORY
① REVOLUTIONARY WAR.	EST. 1850. A PART OF
⑩ WAR OF 1812.	THE U. S. MILITARY LA-
⑮ WAR WITH MEXICO.	ND PATENTED TO UNK-
⑰ CIVIL WAR.	NOWN PERSON. CONVE-
⑳ SPANISH AM. WAR.	YED TO THOMAS GRAY.
㉑ WORLD WAR.	

SCALE 1"=60' APPROX. 0.50 ACRE.

25-7-6

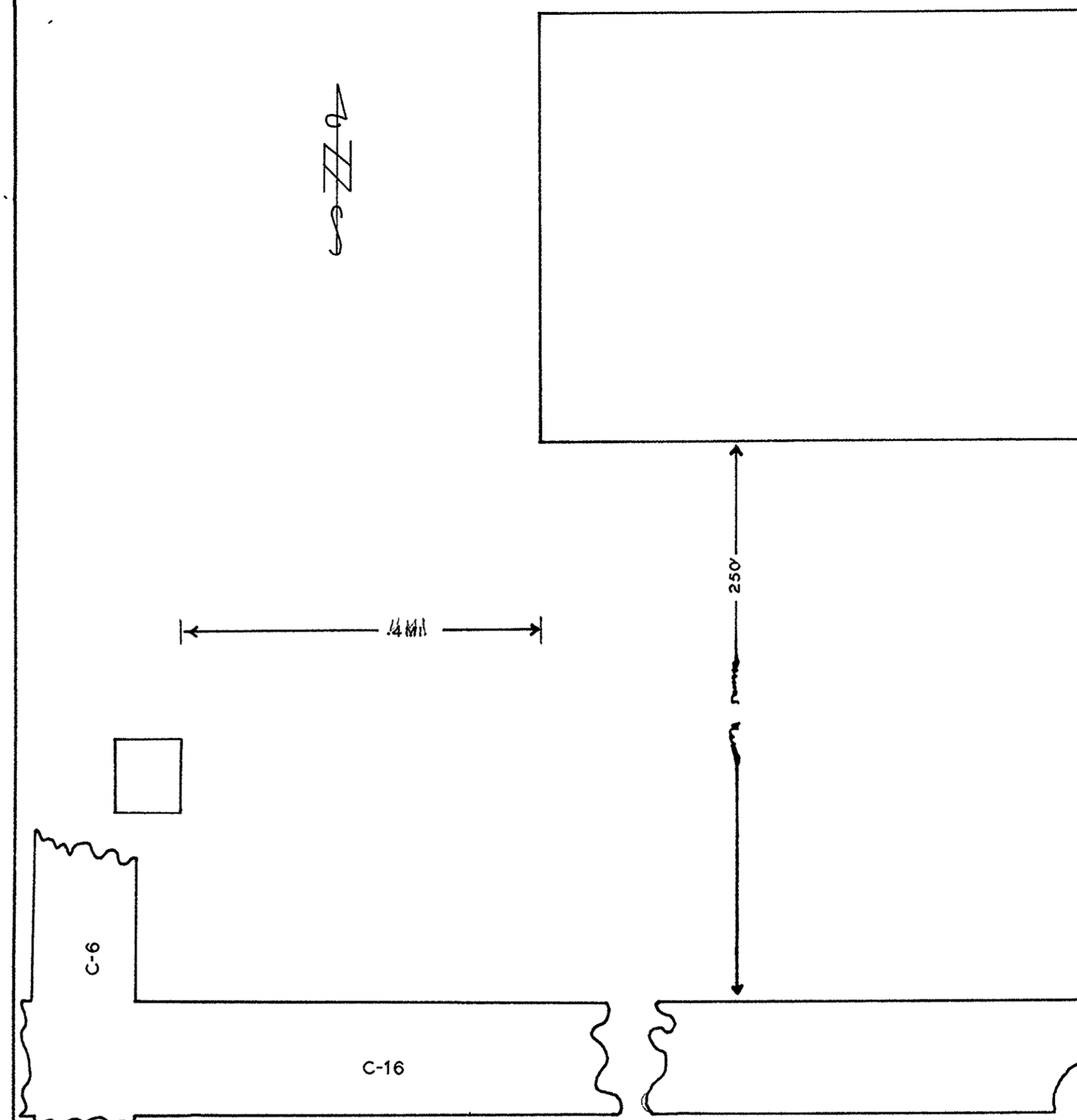

**BALDWIN
CEMETERY**

FRANKLIN CO. JEFFERSON TWP.
OFFICIAL PROJECT NO'S. 465-42-3-467 & 665-42-3-232

LEGEND	HISTORY
① REVOLUTIONARY WAR.	EST. 4-12-1865. PART OF
⑩ WAR OF 1812.	THE ORIGINAL MILITARY
⑮ WAR WITH MEXICO.	LAND GRANTED TO JO-
⑰ CIVIL WAR	NATHAN DAYTON BY U.
⑳ SPANISH AM. WAR.	S PRES. JOHN ADAMS.
㉑ WORLD WAR.	3-20-1800.

SCALE 1"=40' APPROX. 0.75 ACRE.

25-7-3

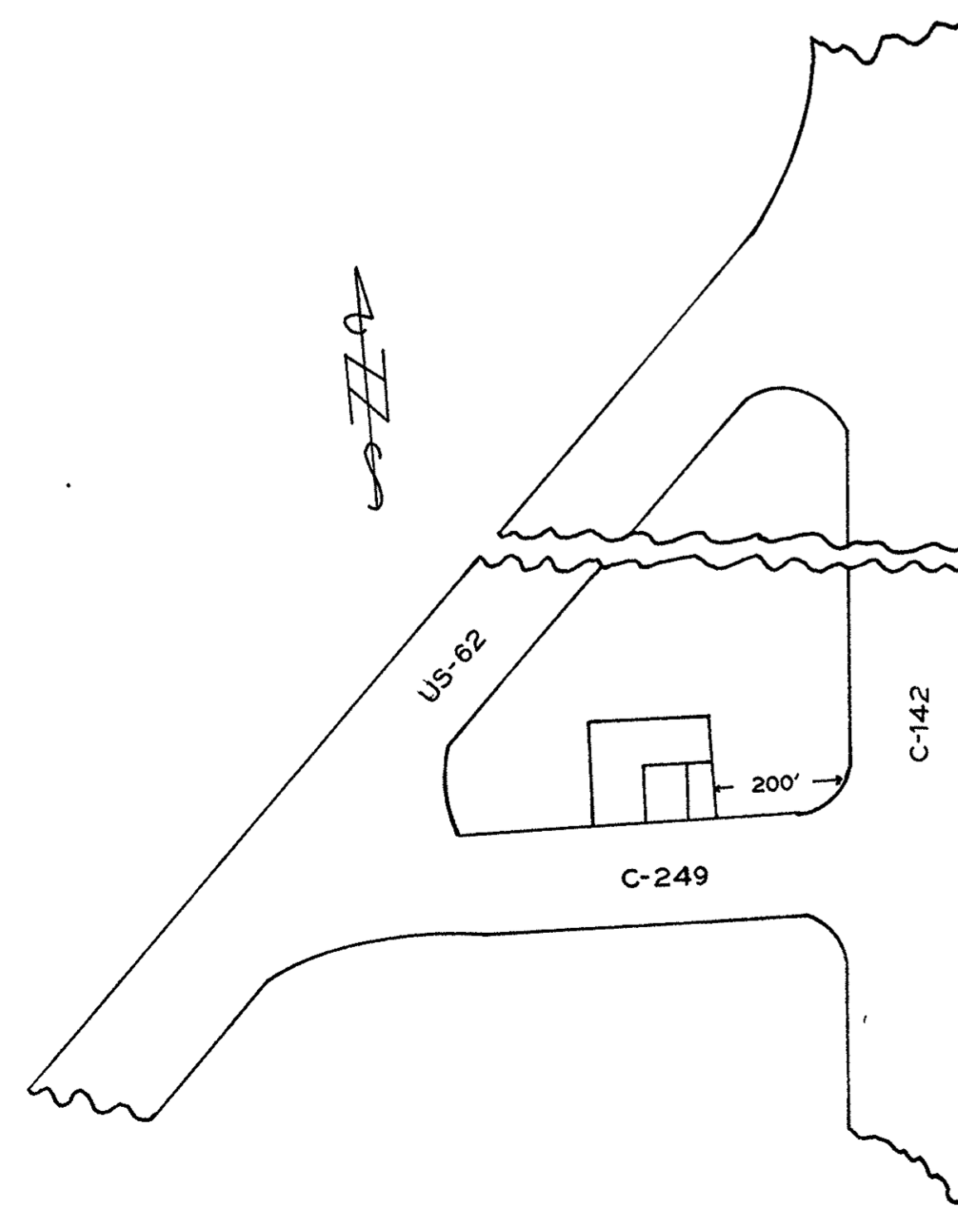

**COLORED CEM. ASS'N.
CEMETERY**

FRANKLIN CO. FRANKLIN TWP.
OFFICIAL PROJECT NO'S. 465-42-3-467 & 665-42-3-232

LEGEND	HISTORY
① REVOLUTIONARY WAR.	EST. 1850. A PART OF VA.
⑩ WAR OF 1812.	MIL. LAND PAT. TO CAP.
⑮ WAR WITH MEXICO.	ROBERT BEAL IN 1800
⑰ CIVIL WAR.	BY U. S. PRES. JOHN AD-
⑳ SPANISH AM. WAR.	AMS. FOR SERV'CS REN-
㉑ WORLD WAR.	DERED IN THE REV. WAR.

SCALE 1"=20' 0.005 ACRE.

25-4-6

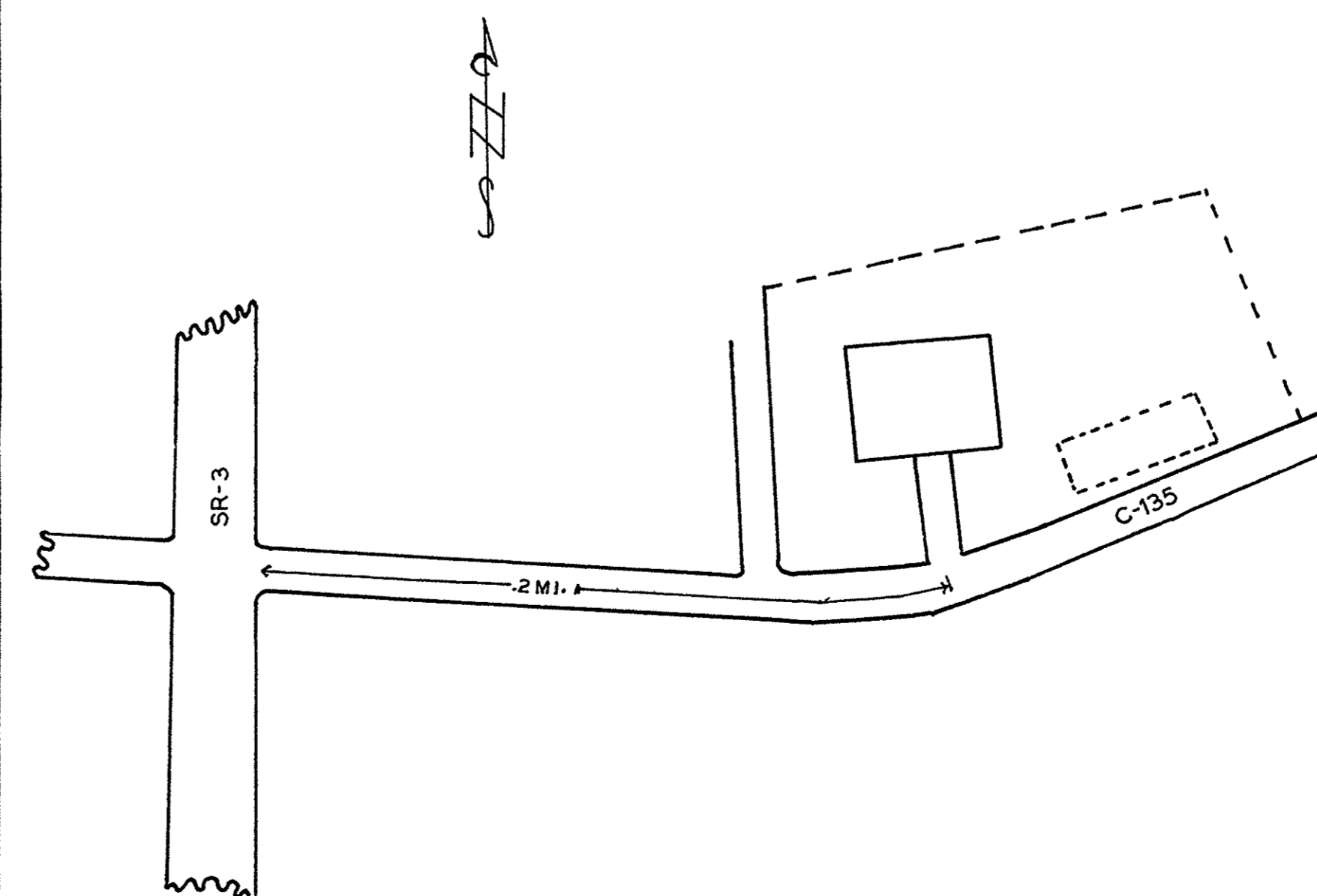

LEGEND
SEC= SECTION L=LOT R=ROW
G=GRAVE W=WAR
X=POSITION UNKNOWN

**GERMAN LUTHERAN
CEMETERY**

FRANKLIN CO. JACKSON TWP.
OFFICIAL PROJECT NO'S. 465-42-3-467 & 665-42-3-232

LEGEND	HISTORY
① REVOLUTIONARY WAR.	EST. 1860. A PART OF
⑩ WAR OF 1812	THE VIRGINIA MILITARY
⑮ WAR WITH MEXICO.	LAND GRANT TO JOS-
⑰ CIVIL WAR.	EPH TAGERT. ASSIGNED
⑳ SPANISH AM. WAR.	TO DANIEL MORGAN
㉑ WORLD WAR.	IN 1800.

SCALE 1"=20' 0.003 ACRE.

25-6-2