

CATHOLIC CEMETERY

FRANKLIN CO. MONTGOMERY TWP.

OFFICIAL PROJECT NO'S. 465-42-3-467 & 665-42-3-232

LEGEND	HISTORY
① REVOLUTIONARY WAR.	EST 110 1845. THE ABOVE LAND BEING A PART
⑩ WAR OF 1812.	OF THE REFUGEE LAND
⑮ WAR WITH MEXICO.	GRANT PATENTED TO
⑲ CIVIL WAR.	SETH HARDING 2-20-
⑳ SPANISH AM WAR.	1802.
⑳ WORLD WAR.	
NOT TO SCALE.	162 ACRE.

25-11-5

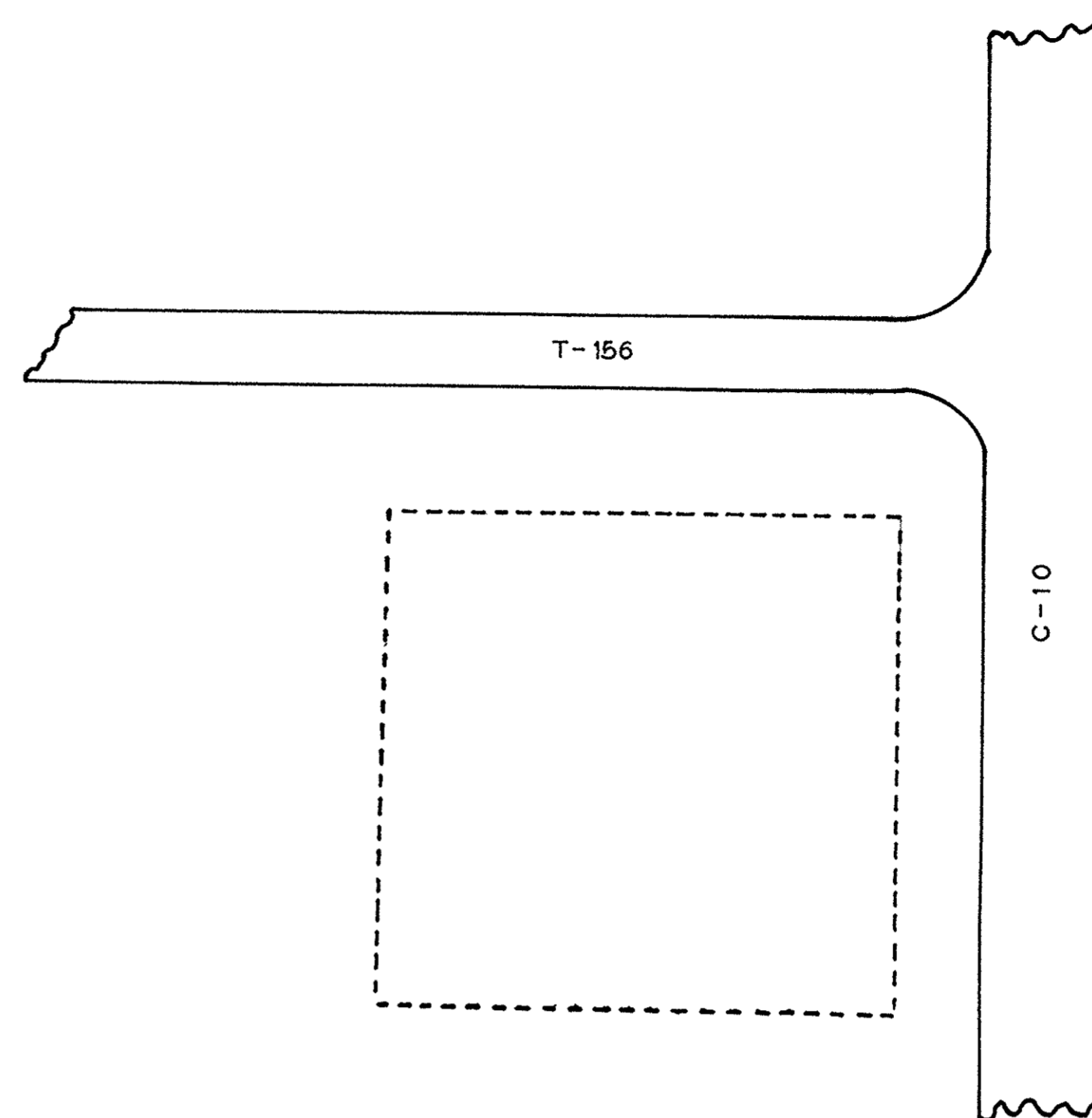

DAVIS CEMETERY

FRANKLIN CO. NORWICH TWP.

OFFICIAL PROJECT NO'S. 465-42-3-467 & 665-42-3-232

LEGEND	HISTORY
① REVOLUTIONARY WAR.	SOLD TO SAM. DAVIS. 1-20-
⑩ WAR OF 1812.	1815. PART OF ORIG. VA MIL.
⑮ WAR WITH MEXICO.	LAND PAT. TO NATH. TER-
⑲ CIVIL WAR.	RY BY U. S. GOV. M. DAVIS
⑳ SPANISH AM. WAR.	THO'T. TO BE 1ST. ONE BU-
⑳ WORLD WAR.	RIED. HE DIED ABOUT 1845.
SCALE 1"=20'	0.10 ACRE.

25-12-2

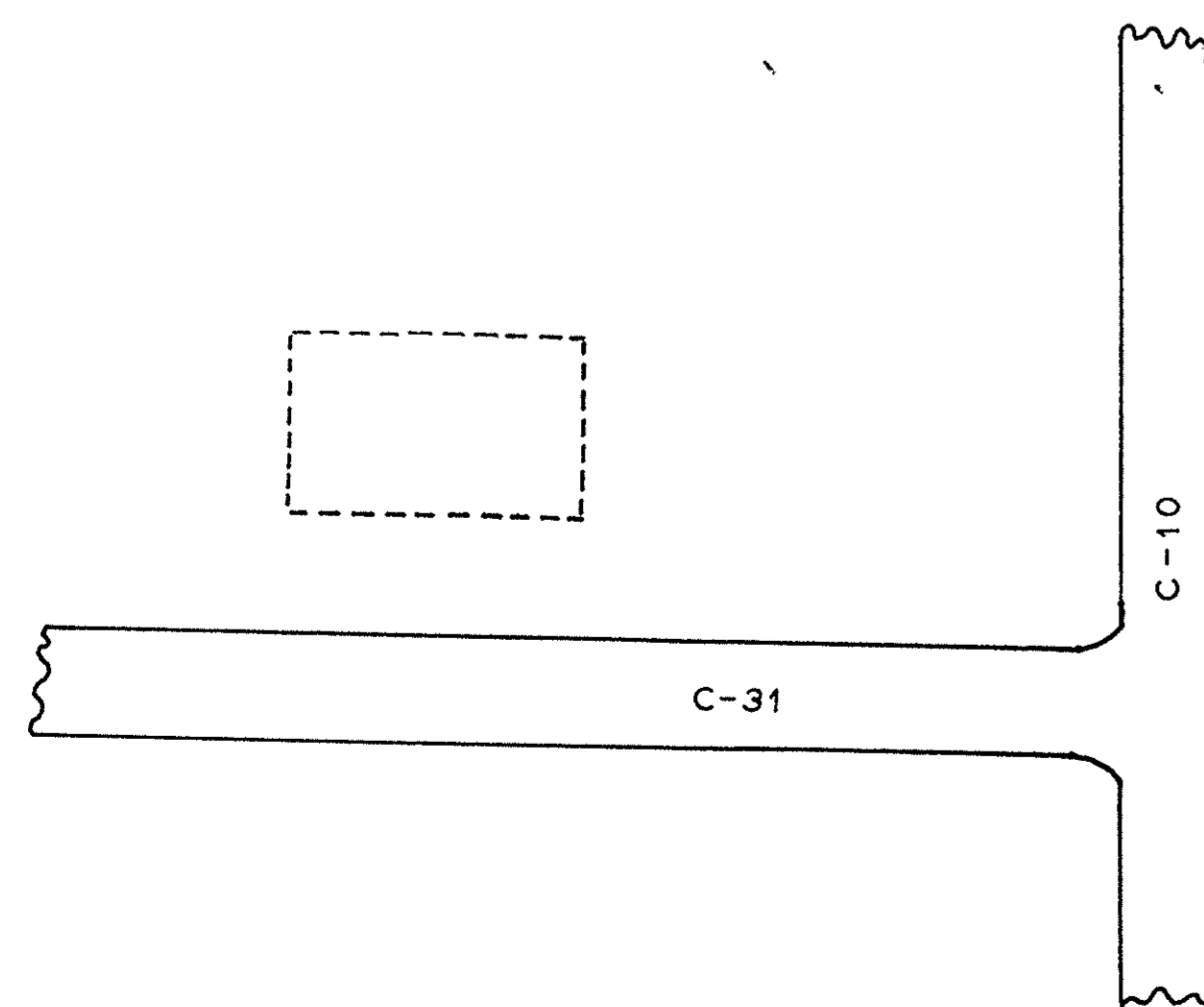

DOBYNS CEMETERY

FRANKLIN CO. NORWICH TWP.

OFFICIAL PROJECT NO'S. 465-42-3-467 & 665-42-3-232

LEGEND	HISTORY
① REVOLUTIONARY WAR.	EST. DATE UNKNWN, PART
⑩ WAR OF 1812	OF ORIG VA. MIL. LAND PAT.
⑮ WAR WITH MEXICO.	TO JOSEPH KERR BY U. S.
⑲ CIVIL WAR.	PRES. THOMAS JEFFERSON.
⑳ SPANISH AM WAR.	4-13-1807. NO REC OF A CEM.
⑳ WORLD WAR.	UP TO AND INCLUDING THE
NOT TO SCALE.	DEED TO GODF A HORST IN 1899&1905. 0.50 ACRE.

25-12-1

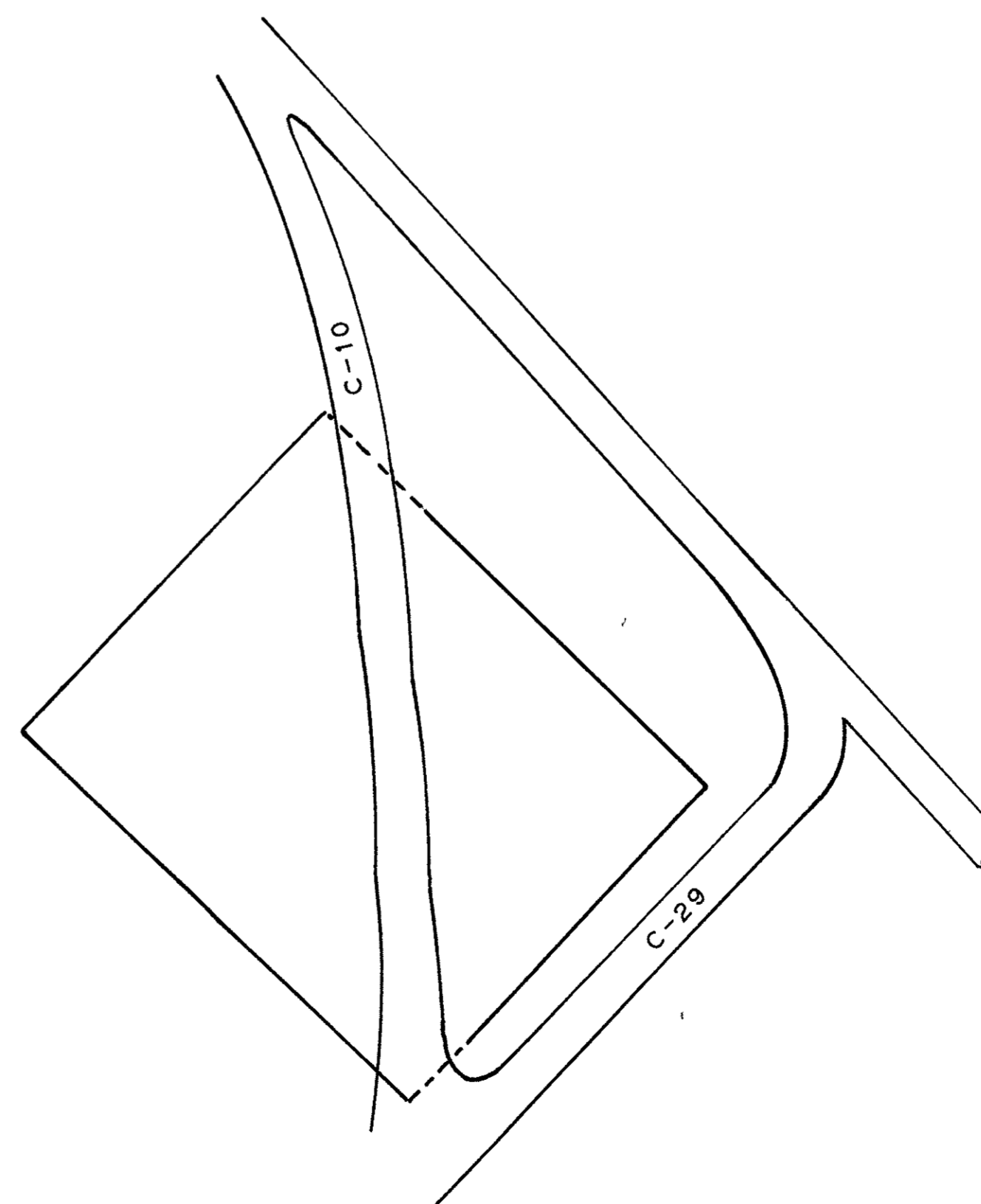

FRANKLIN CO. COM'S CEMETERY

FRANKLIN CO. NORWICH TWP.

OFFICIAL PROJECT NO'S. 465 42 3 467 & 665 42 3 232

LEGEND
SEC=SECTION L=LOT R=ROW
G=GRAVE W=WAR
*POSITION UNKNOWN

LEGEND	HISTORY
① REVOLUTIONARY WAR.	APPROX. EST. DATE 1830.
⑩ WAR OF 1812	A PART OF THE VIRGIN-
⑮ WAR WITH MEXICO.	IA MILITARY LAND PATE-
⑲ CIVIL WAR.	NATED TO THOMAS POSEY
⑳ SPANISH AM. WAR	BY U. S. PRES JNO. ADAMS
⑳ WORLD WAR.	IN 1798.
SCALE 1"=40'	0.50 ACRE.

25-12-9